

# HPV35/55/70/90/110/160

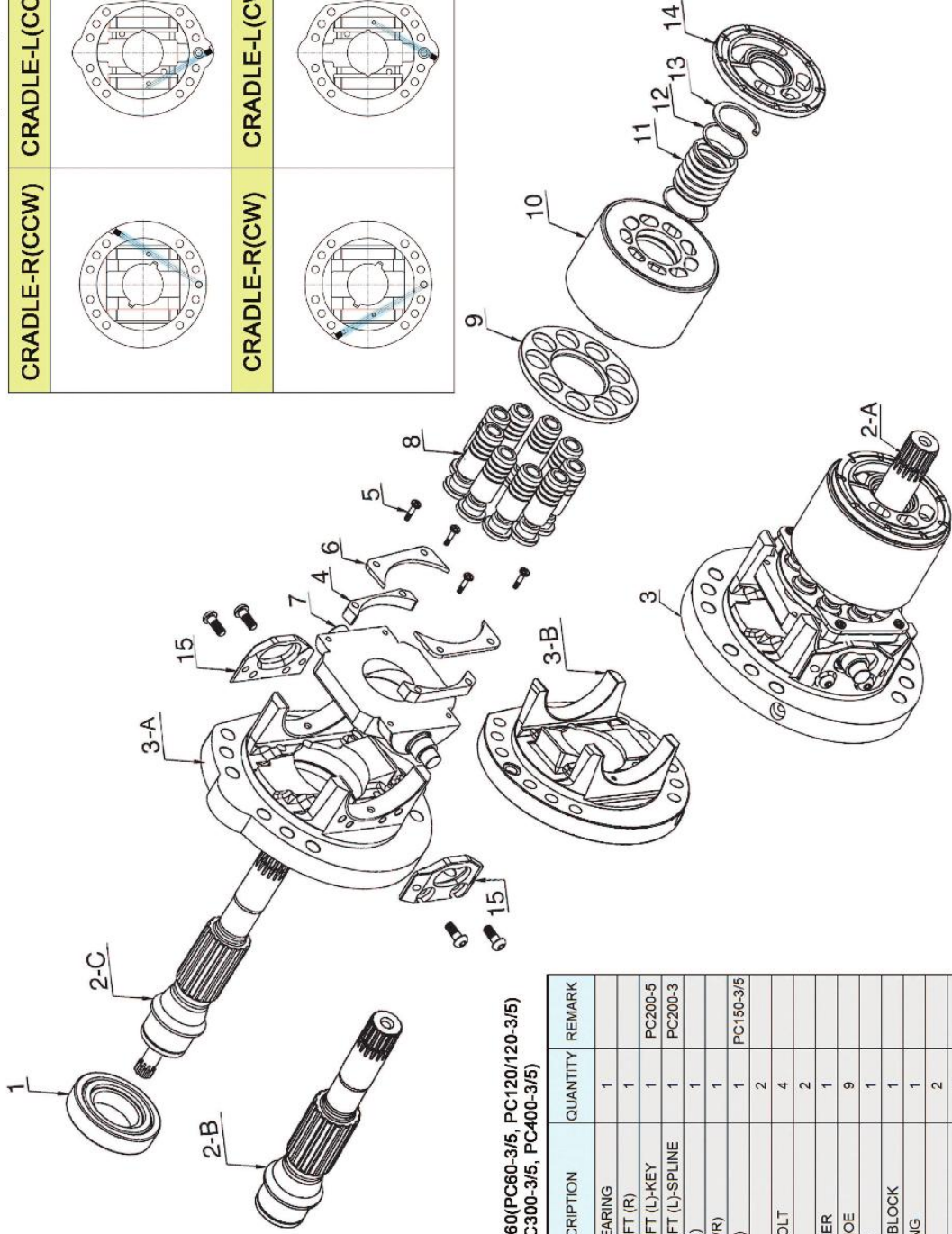

IT IS DIFFERENT SHAPE BETWEEN CCW AND CW TYPE OF HPV90(PC200-3) CRADLE

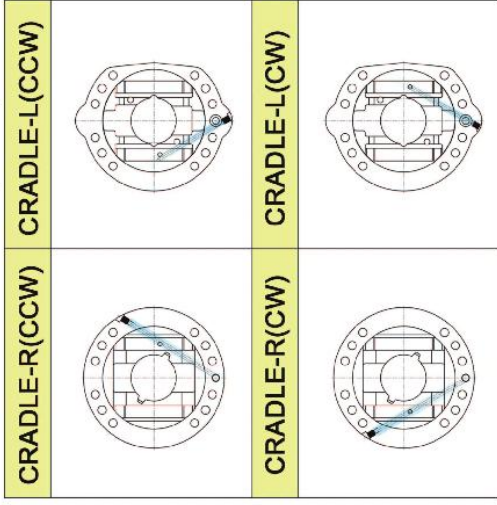

HPV35/55/70/90/160(PC60-3/5, PC120/120-3/5)  
PC200/220-3/5, PC300-3/5, PC400-3/5)

ITEM	DESCRIPTION	QUANTITY	REMARK
1	ROLLER BEARING	1	
2-A	DRIVE SHAFT (R)	1	
2-B	DRIVE SHAFT (L)-KEY	1	PC200-5
2-C	DRIVE SHAFT (L)-SPLINE	1	PC200-3
3	CRADLE (R)	1	
3-A	CRADLE (L/R)	1	
3-B	CRADLE (L)	1	PC150-3/5
4	SPACE	2	
5	SOCKET BOLT	4	
6	FIX PLATE	2	
7	CAM ROCKER	1	
8	PISTON SHOE	9	
9	SET PLATE	1	
10	CYLINDER BLOCK	1	
11	COIL SPRING	1	
12	WASHER	2	
13	SNAP RING	1	
14	VALVE PLATE (L/R)	1	
15	THRUST BEARING	2	

HAN DOK HYDRAULIC



# HPV35/55/70/90/110/160



IT IS DIFFERENT SPACE THICKNESS

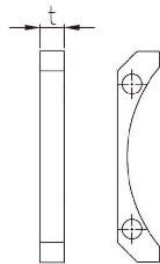

TYPE	SPACE THICKNESS(t)		
	A	B	C
HPV35 (PC60-3/5)	8.00	8.03	8.05
HPV55 (PC120/120-3/5)	9.44	9.46	9.475
HPV70/90 (PC200/220-3/5)	11.54	11.56	11.575
HPV160 (PC300/400-3/5)	13.54	13.56	13.575

IT IS DIFFERENT VALVE PLATE & CRADLE SHAPE(HPV35/55/70/90/160)

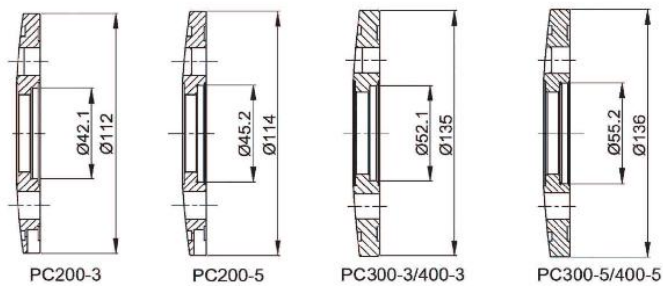

(CW)

(CCW)

